

QUICK INSTALLATION GUIDE

HARDENED MANAGED SWITCH

Front Panel

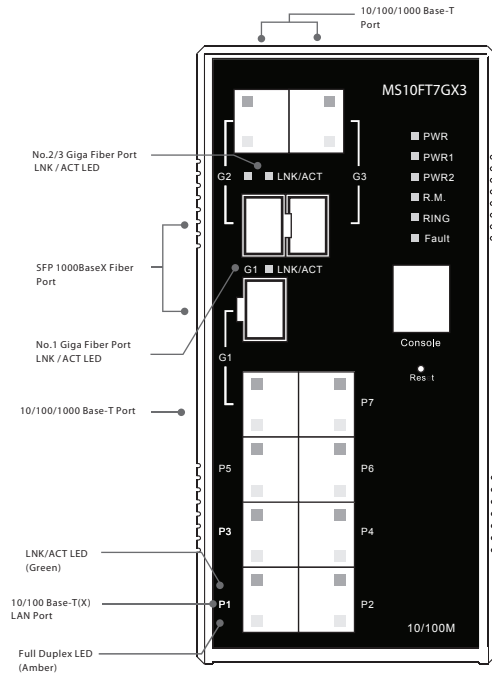

Installation

DIN-Rail Install Step

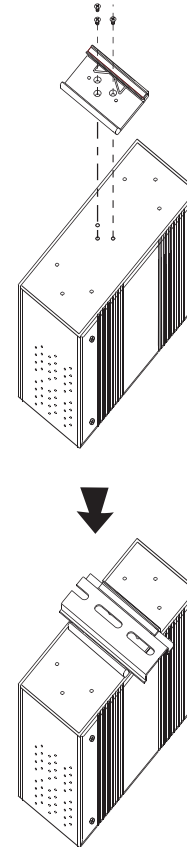

Wall-mounted Install Step

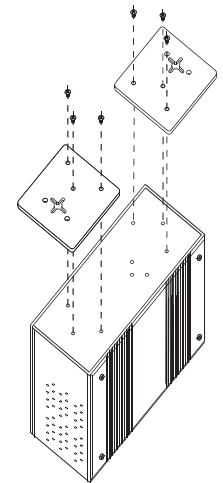

Power Connection Guide

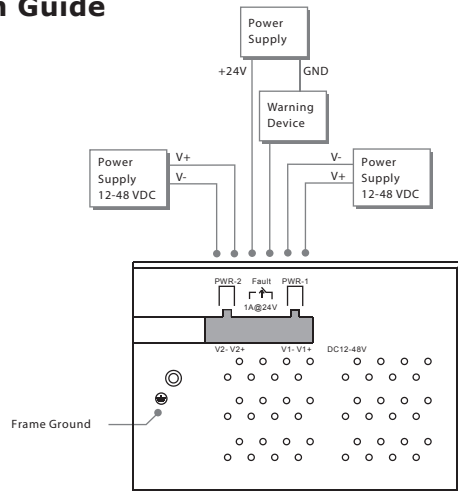

QUICK INSTALLATION GUIDE

HARDENED MANAGED SWITCH

Accessory

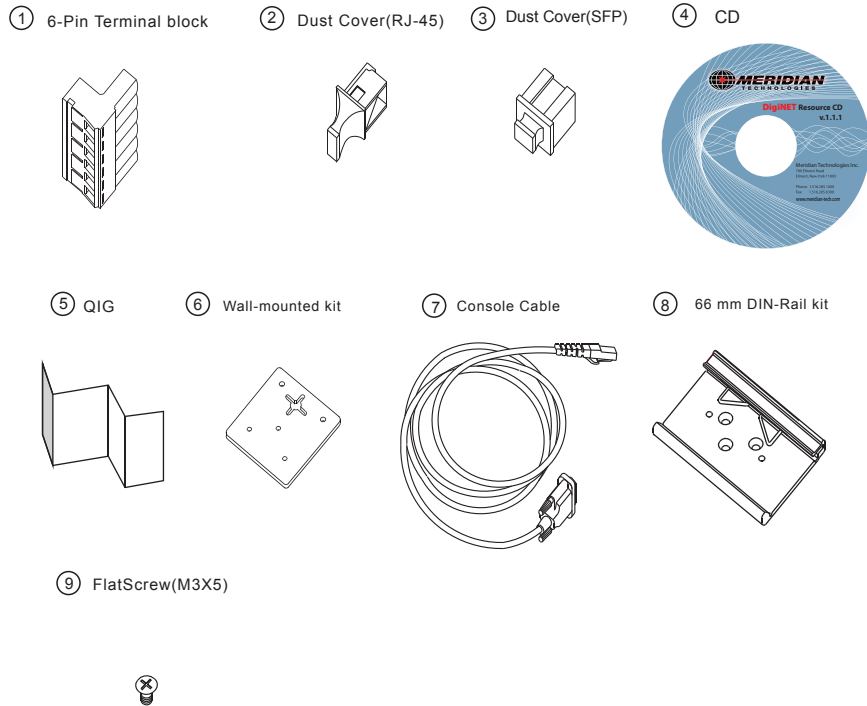

Packing list

Model name	Model Description	Accessory
MS10FT7GX3	Industrial 10-port managed PoE Ethernet Switch with 7x10/100Base-TX P.S.E. and 3xGigabit combo ports, SFP socket	①X1, ②X10, ③X2, ④X2, ⑤X1, ⑥X1, ⑦X2, ⑧X1, ⑨X6

Communication Connections

10/100Base-TX Ethernet Port Connection

RJ45 (8-pin,MDI) Port Pinouts

Pin	Signal
1	Tx+
2	Tx-
3	Rx+
6	Rx-

RJ45 (8-pin,MDI-X) Port Pinouts

Pin	Signal
1	Rx+
2	Rx-
3	Tx+
6	Tx-

1000Base-T Ethernet Port Connection

RJ45 (8-pin,MDI) Port Pinouts

Pin	MDI
1	BI_DA+
2	BI_DA-
3	BI_DB+
4	BI_DC+
5	BI_DC-
6	BI_DB-
7	BI_DD+
8	BI_DD-

RJ45 (8-pin,MDI-X) Port Pinouts

Pin	MDI-X
1	BI_DB+
2	BI_DB-
3	BI_DA+
4	BI_DD+
5	BI_DD-
6	BI_DA-
7	BI_DC+
8	BI_DC-

RJ45 (8-pin) to RJ45 (8-Pin) Straight-Through Cable Wiring

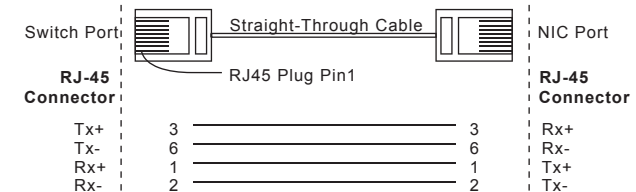

RJ45 (8-pin) to RJ45(8-Pin) Cross-Over Cable Wiring

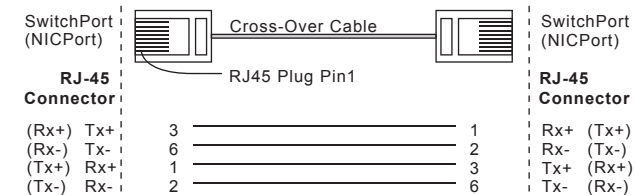

1000Base-X SFP Port Connection

